

# Installation Instructions & Use Recommendations

## FMS Accessories – Carpuride TFT Mount

These instructions must be read carefully and thoroughly **before** beginning work. FMS Solutions, LLC accepts no liability for damage caused by failure to observe the installation instructions or use recommendations.

**Installation of this accessory does not change the factory specified load limits for the motorcycle.**

**Note:** Installation of this mount on TFT dashboard models requires drilling holes in the top dashboard surface!



### Preparing the Display for Mounting:

The Carpuride W702 display has a 1" ball mount on the back. Using a Phillips screwdriver, remove the center screw and release the ball from the mounting pedestal.

Clean the M4 x 0.7 threads using a "Q-tip" to remove any contaminants, thread locking compound, etc.

The FMS mounts capture the pedestal and secure the display to the mount, providing a strong, theft-resistant mounting.



### BMW NAV Dashboard Mounting:

For TFT models, the W702 display must be attached to the mount prior to attaching to the bracket. Using the M4 x 25 screw with Vibratite on the threads, secure the W702 display to the TFT Mount. Apply only moderate tension – this is a plastic part.

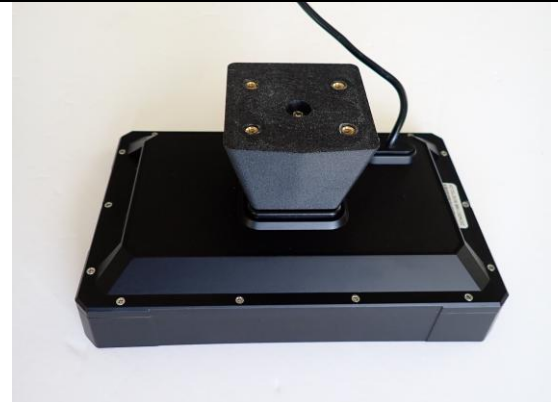

Remove the BMW windshield bolts #5 and trim strips #4. Carefully hold the windshield #1 and set in a safe place.

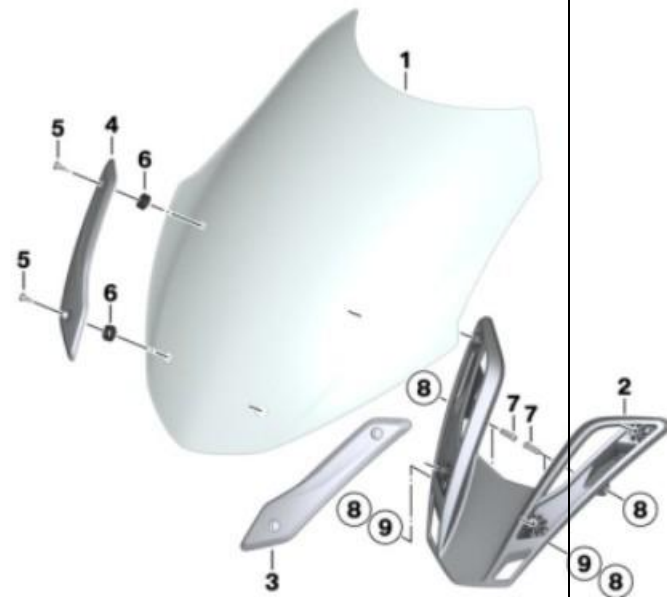

Position the assembly on the dash panel, with the bracket positioned as far forward as it will go. Mark the four hole locations.

It is advisable to drill the two most forward holes first. Drill one hole at a time, then insert the expanding rivet, drill the other. Follow up by drilling the two closest to the TFT screen.



**You may skip this step if you do not intend to run the cable down through the top of the dashboard or do not have a hole to plug from the XM antenna.**

Using a large Uni-Bit, drill out the center hole so that the grommet fits inside the hole. The grommet is mounted in the bracket, but it must be able to extend through the hole.

Use this opening to route radar cables as the fairing bodywork is very precise with no gaps to otherwise route cables.

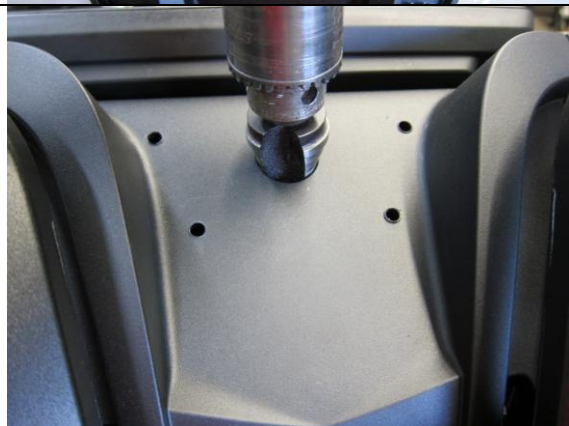

Press the grommet into the bracket so that it locks to the bracket frame. Mount the bracket using the four (4) M6 push rivets supplied. Start with the forward edge and secure those two rivets first, then the two rivets nearest the TFT display. Note that once those rivets are installed, it is difficult to remove them. One method to remove the push rivets is screw a thin drywall screw just into the pin – then pull out.



Screw the Carpuride base block to the FMS NAV bracket provided with the kit. Tighten the four (4) M4 x 12 flanged screws snugly.

Additional hardware packages are available from FMS Accessories <https://fmsaccessories.com/hardware-set-tft-display-mounts>

Reinstall windshield in reverse order.



**Civilian Models:** If the factory SAT radio antenna is present, it must be removed. Unscrew the mounting bolt from below, unplug the antenna and remove it. Abandon the SAT radio antenna wire. If you use your XM subscription, you should connect a different antenna at the rear, directly to the radio under the passenger seat (similar to the one shown at right from Amazon with Fakra connector). It is reported by customers that mounting this type of antenna to the top of the rear turn signal housing works well with or without top case.



The Carpuride W702 comes with a generic connection harness with in-line fuse. To use the BMW NAV power connection, trim the harness to 36" and install the BMW NAV connector plug available separately.

Positions: #1 = Ground #2 = Unused #3 = Power

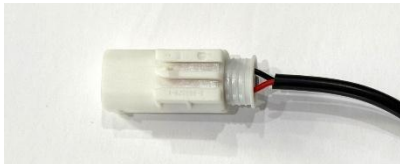

On models fitted with charging cradles, there is a GPS connection plug, emanating from the cable leading to the LH handlebar switch. It is right near the frame / air filter area. This plug is the factory connection which includes power, ground and LIN communications. You will need to look for it!



If you are connecting a GPS cradle / mount that is not from BMW, you likely do not have the 3x connector needed to plug into the GPS plug as noted above.

FMS Accessories has these plugs available for you to splice into your aftermarket cradle cable so that your BMW connectors remain intact. <https://fmsaccessories.com/sealed-bmw-electrical-connector-sets>

Pin #1 = Ground (Black)  
Pin #2 = LIN (Violet - If Functioning or blue seal plug)  
Pin #3 = 12V Power (Red)



Alternatively, FMS offers two easy “Y” connections to the RH power socket for connection of a generic GPS that doesn’t require BMW connections or for a BMW cradle where the factory GPS power plug is not available.

<https://fmsaccessories.com/nav-wiring-connection-harness>



**Feedback:** Thank you for your purchase and we welcome your feedback as we too want to make every accessory exceed your expectations. Report any comments, suggestions, problems or concerns to FMS Solutions, LLC at [info@fmsaccessories.com](mailto:info@fmsaccessories.com) .

**FMS Solutions, LLC Limited Warranty**

FMS Solutions, LLC warrants to the first retail purchaser of new FMS Accessory products, to be free from defects in materials or workmanship, for a period of three (3) years from the original date of purchase as noted on the FMS Solutions, LLC invoice or original dealer invoice, except for paint and powder-coated finishes, which are warranted for the first 12 months only. LED lights from Fenix, Inc., Code 3, Inc. and Littlite are covered for 5 years by their manufacturer’s respective warranties – processed through FMS Solutions, LLC.

**This warranty extends only to the FMS accessory and does not include:** damage caused by accidents or abuse; incorrect installation; labor to diagnose, remove, repair or replace; any consequential damage or loss of use. Any FMS Accessory suspected of being defective should be returned to FMS Solutions, LLC along with a copy of proof of purchase and warranty request form available on the FMS website. FMS Solutions, LLC will determine if the FMS accessory has a warrantable defect, and if so, will repair or replace the item and return it to the sender without charge. The decision to repair or replace said item is solely the prerogative of FMS Solutions, LLC.

**Note:** Police motors can operate in a very rough environment since police motors are a “tool”. They can be dropped, knocked over, etc. without concern as the officer has a job to do and determines what is necessary at any given moment. Warranty is for defects in materials or workmanship. Therefore, the ability of an item to become broken or damaged does not mean it is warranty ... it just means it is broken or damaged and in need of repair or replacement. No manufacturer warrants their products to be indestructible. Any questions should be directed to [info@fmsaccessories.com](mailto:info@fmsaccessories.com) .